

PROJECT
**SAN JOAQUIN CO.
 SUPERIOR COURT**

MANTECA

**DIVISION
 EXPANSION**

CLIENT JOB # ARCHITECT JOB #
 P1006

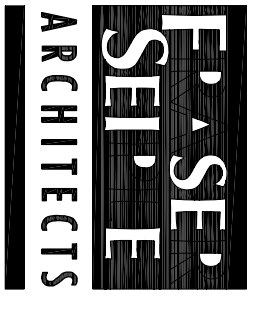

PROJECT MANAGER BOF

DRAWN BY BS

DATES 11-19-10

SIGNED

The use of these plans and specifications shall be restricted to the original site for which they were prepared and publication in any other form, including electronic, is prohibited without the prior written consent of the architect. The use of these plans and specifications in any other project is prohibited. The use of these plans and specifications shall constitute prima facie evidence of the acceptance of these restrictions. Written dimensions on these drawings shall have precedence over scaled dimensions. Contractors shall verify and be the responsible for the accuracy of all dimensions and shall report any discrepancies to the architect for resolution prior to commencing work.

SHEET TITLE

SITE PLAN

SHEET #

1

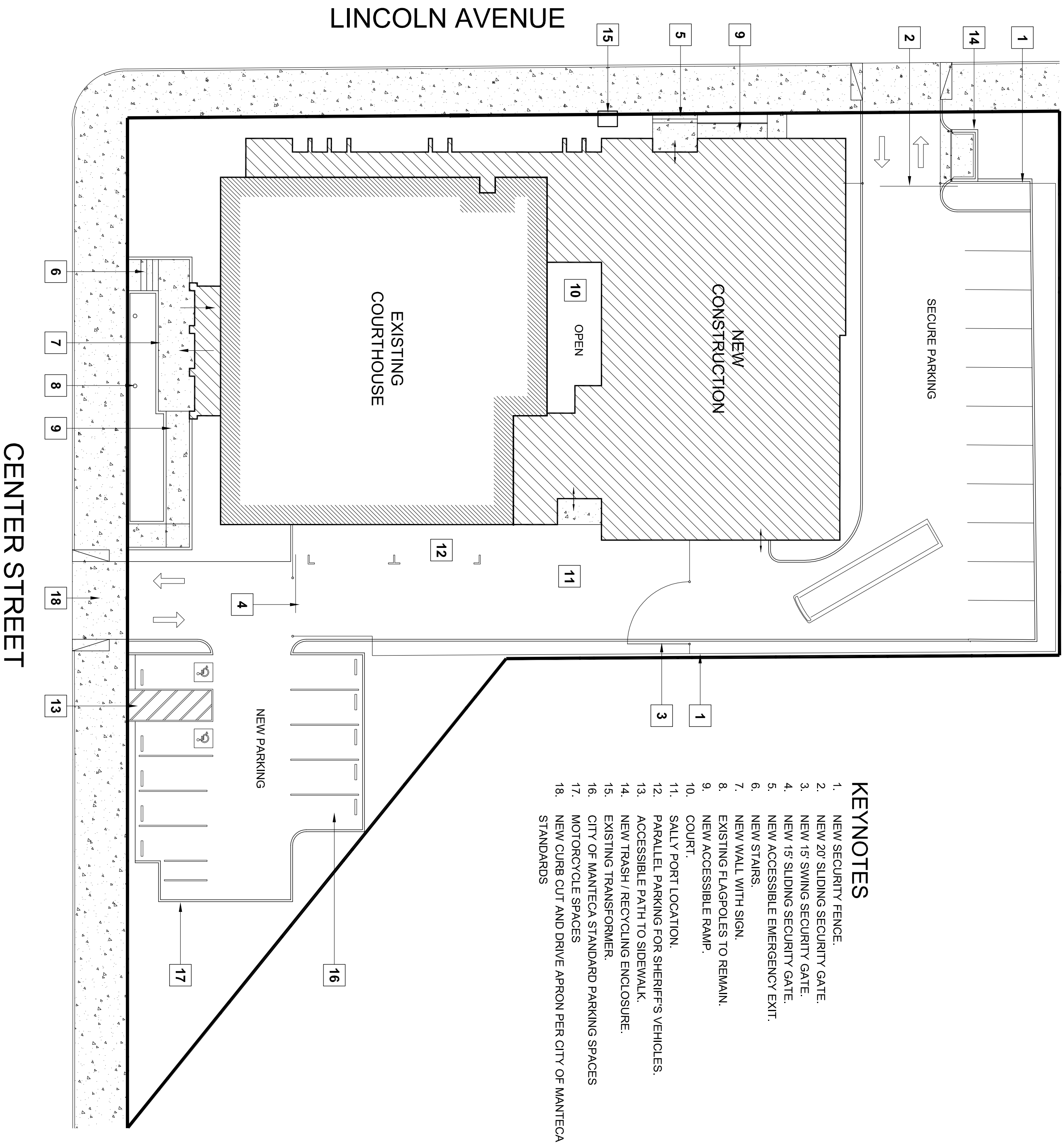

- KEYNOTES**
1. NEW SECURITY FENCE.
 2. NEW 20' SLIDING SECURITY GATE.
 3. NEW 15' SWING SECURITY GATE.
 4. NEW 15' SLIDING SECURITY GATE.
 5. NEW ACCESSIBLE EMERGENCY EXIT.
 6. NEW STAIRS.
 7. NEW WALL WITH SIGN.
 8. EXISTING FLAGPOLES TO REMAIN.
 9. NEW ACCESSIBLE RAMP.
 10. COURT.
 11. SALLY PORT LOCATION.
 12. PARALLEL PARKING FOR SHERIFF'S VEHICLES.
 13. ACCESSIBLE PATH TO SIDEWALK.
 14. NEW TRASH / RECYCLING ENCLOSURE.
 15. CITY OF MANTECA STANDARD PARKING SPACES.
 16. EXISTING TRANSFORMER.
 17. MOTORCYCLE SPACES.
 18. NEW CURB CUT AND DRIVE APRON PER CITY OF MANTECA STANDARDS.

SITE PLAN
 SCALE: 20" = 1'-0"